

Per porte su vie di esodo - For doors en escape routes - Pour portes sur voies d'évacuation

- Le caratteristiche di sicurezza di questo prodotto sono di importanza fondamentale ai fini della sua conformità alla EN 1125. Non sono ammesse modifiche di nessun tipo, fatta eccezione per quelle che sono descritte in queste istruzioni.
- The features of this panic device are of utmost importance for people's safety. Therefore in no case may any changes be made to the product.
- Les caractéristiques de cette barre anti-panique sont très importantes pour la sécurité des personnes. Aucune modification du produit ne sera admise.

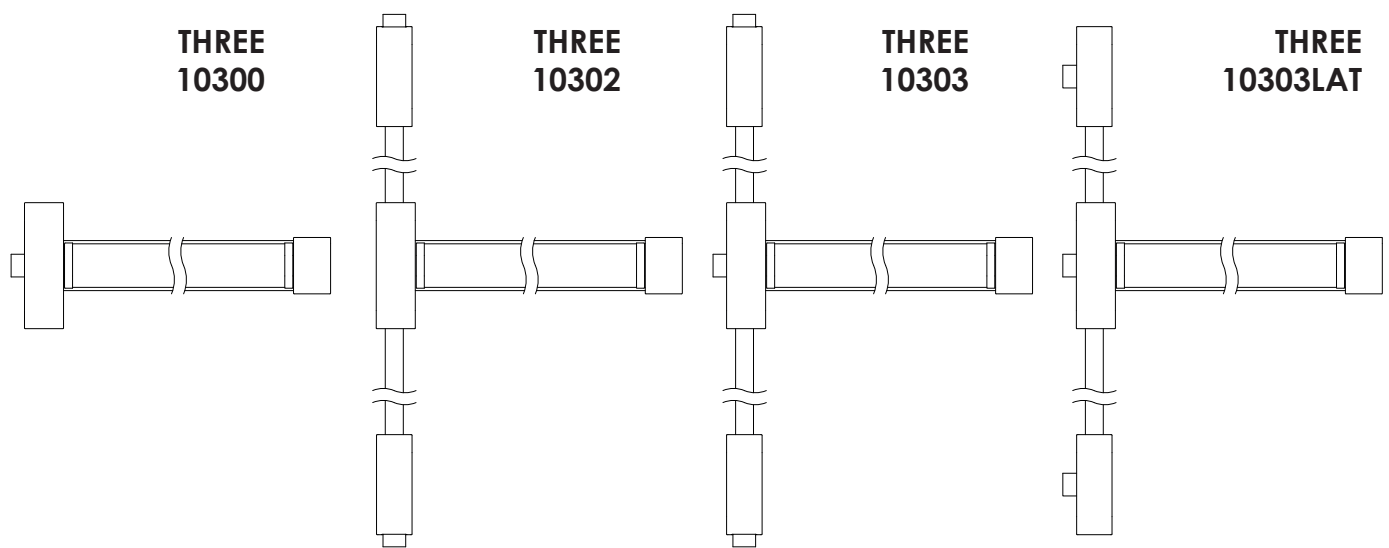

Lavorazioni profilo - Machining the profile - Usinage sur le profil

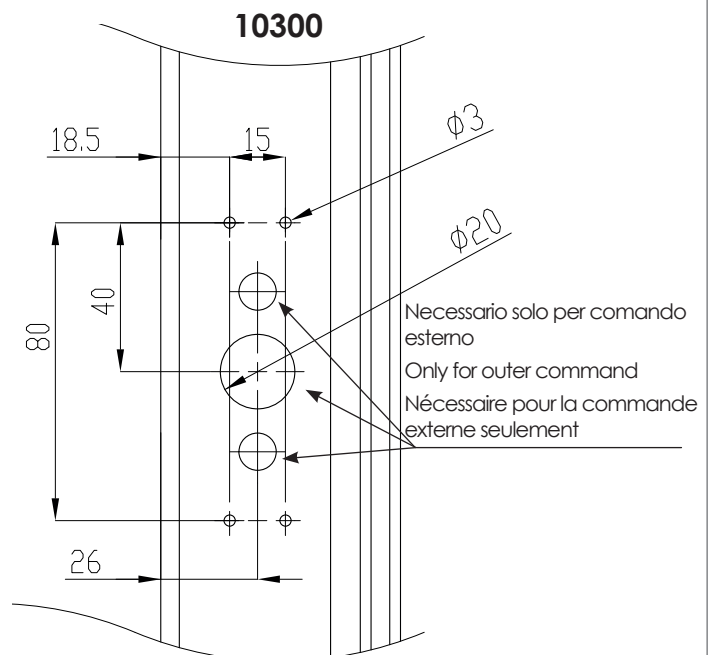

- Eseguite le lavorazioni sul profilo, fissare il maniglione con le viti in dotazione V3 (8 viti in dotazione autofilettanti Ø 3,9 mm. Eseguire un foro di Ø 3,0 mm.)
- After completing work on the profile, fasten the push bar in place using V3 screws provided (8 self-tapping screw, Ø 3,9mm. Drill a Ø 3,0 mm. hole.)
- Procéder aux opérations sur le profil et fixer la barre à l'aide de vis fournis V3 (8 vis taraudeuses Ø3,9 mm. Percher un trou de Ø 3,0 mm.)

- Eseguite le lavorazioni sul profilo, fissare il maniglione con le viti in dotazione V3 (16 viti in dotazione autofilettanti Ø 3,9 mm. Eseguire un foro di Ø 3,0 mm.)
- After completing work on the profile, fasten the push bar in place using V3 screws provided (16 self-tapping screw, Ø 3,9mm. Drill a Ø 3,0 mm. hole.)
- Procéder aux opérations sur le profil et fixer la barre à l'aide de vis fournis V3 (16 vis taraudeuses Ø3,9 mm. Percher un trou de Ø 3,0 mm.)

10302
10303

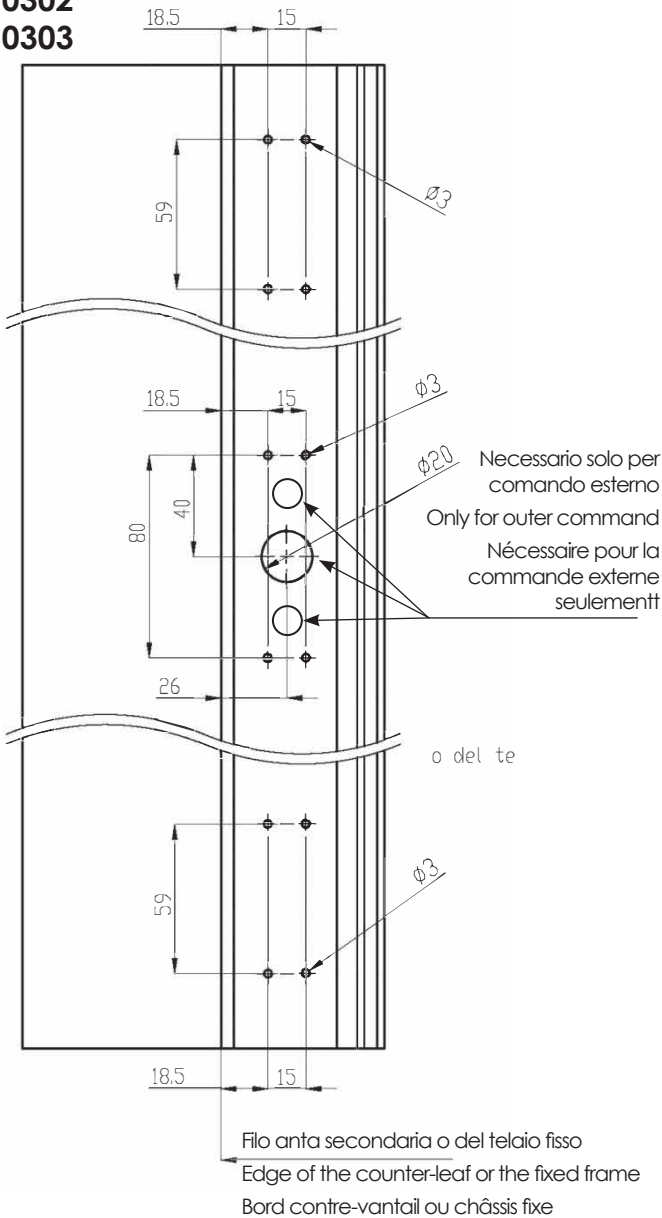

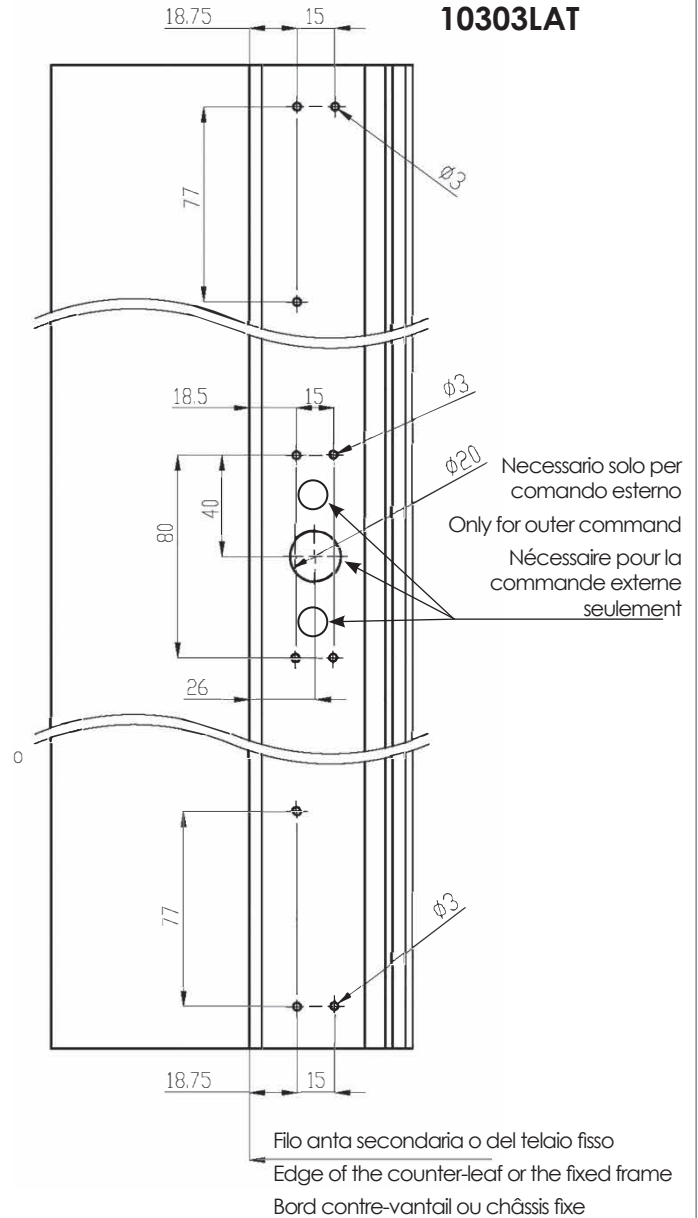

10303LAT

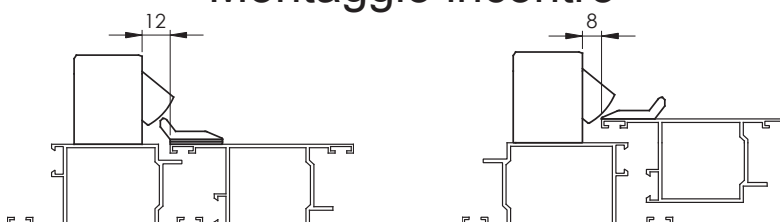

Montaggio incontro

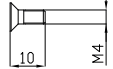

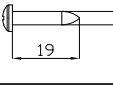
Viti di fissaggio - Fixing screws Vis de blocage			
V1	3	 Torx T20	
V2	6		

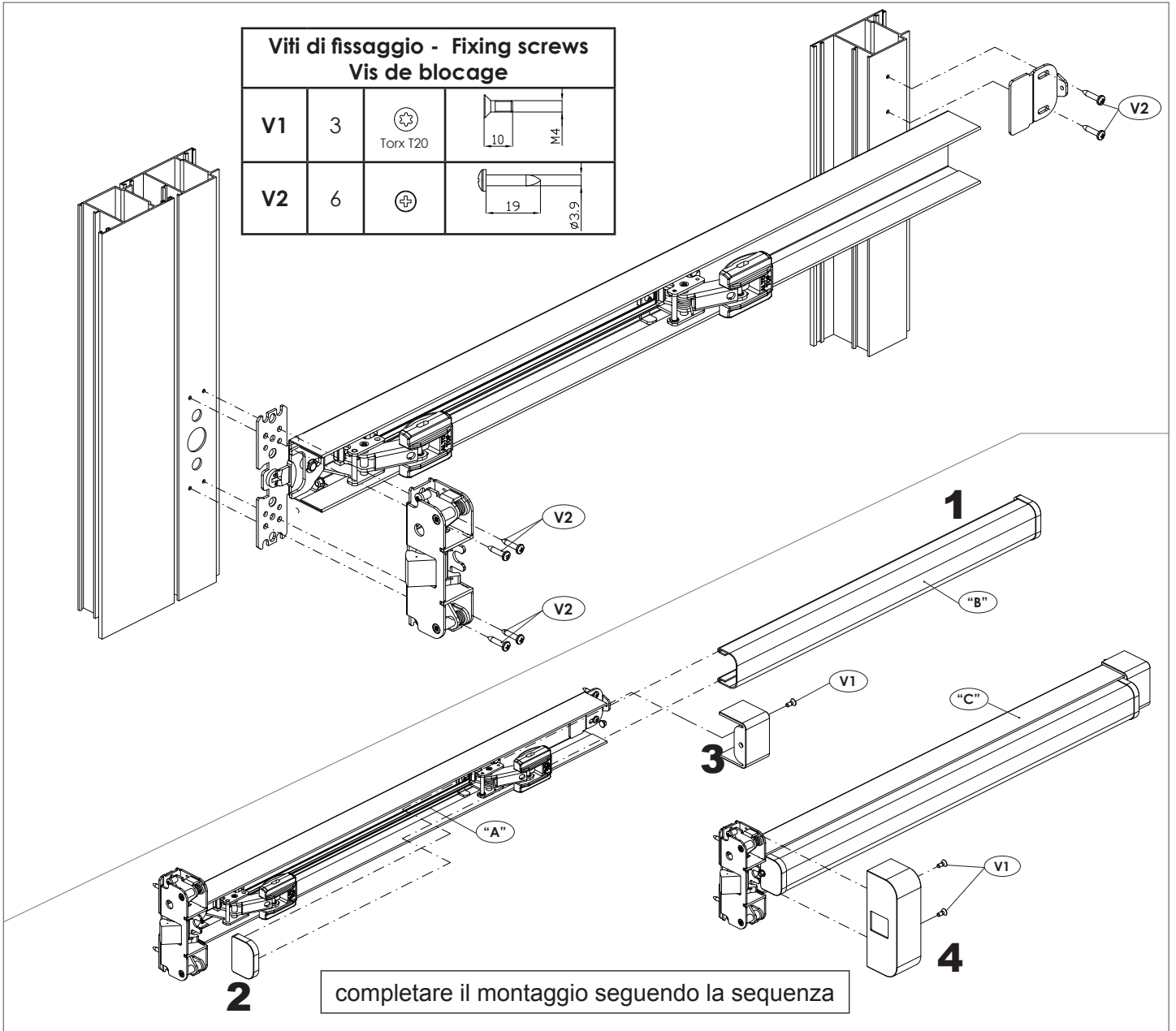

Riduzione lunghezza barra pulsante

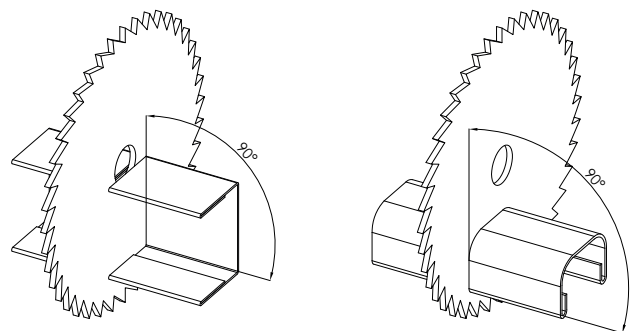
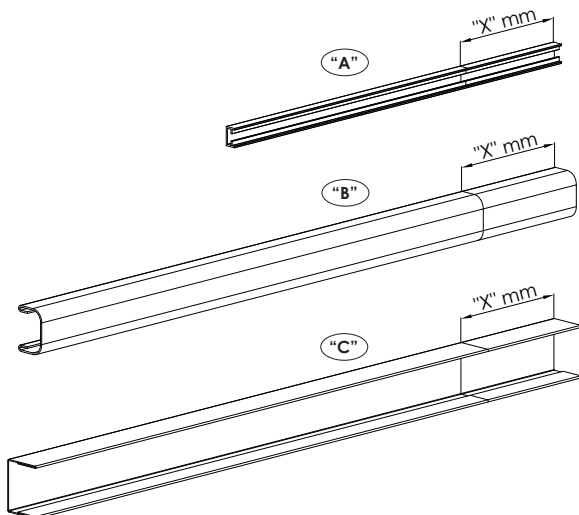

ATTENZIONE:





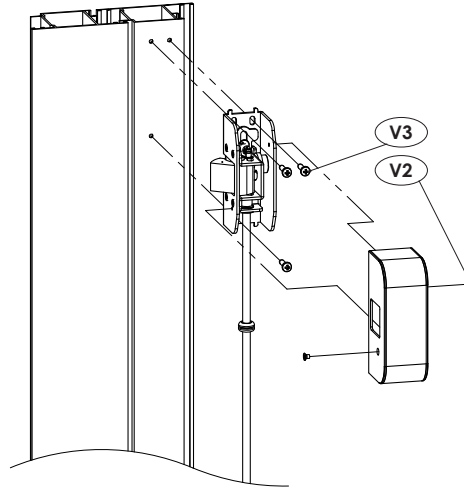
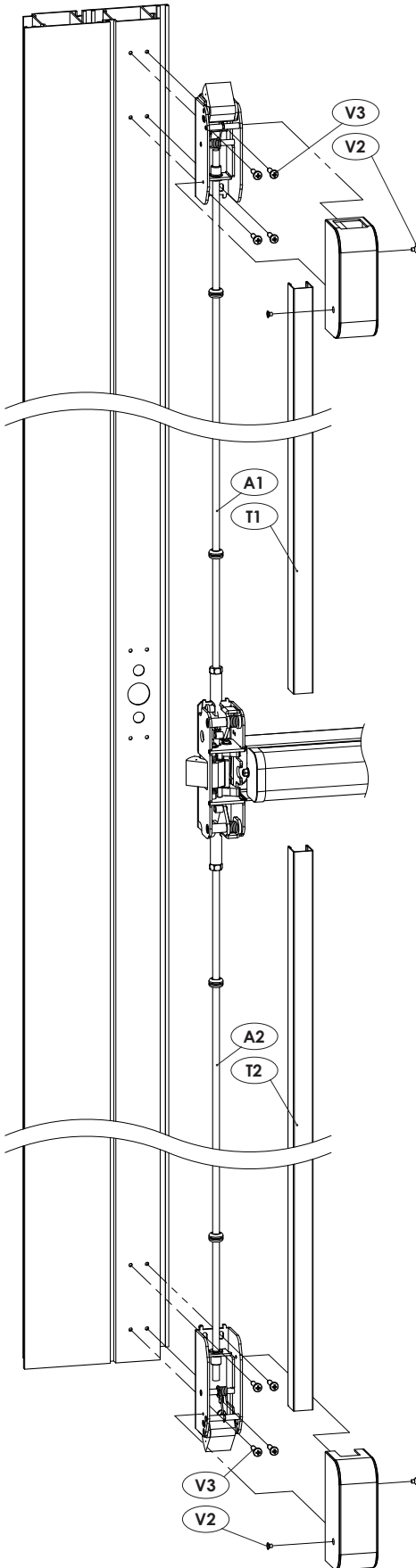
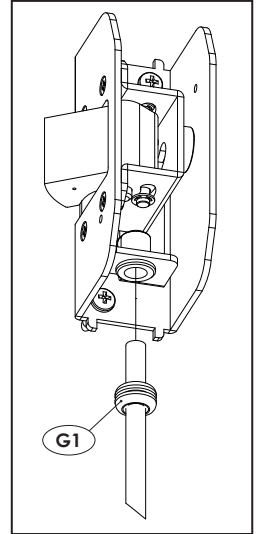

- A TAGLIARE ORTOGONALMENTE AI PIANI;
- UTILIZZARE ATTREZZATURA SPECIFICA PER IL TAGLIO DEL ACCIAIO INOX;
- ACCORCIARE IN MISURA UGUALE I TRE PROFILI.

10302
10303

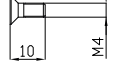
10303LAT

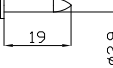

**Viti di fissaggio - Fixing screws
Vis de blocage**

Fixing screws	Laterale/Side Latéral	Alto Basso Up Down Haut Bas		
V2	4		 Torx T20	
V3	6	8		
D1	2			
G1	4			

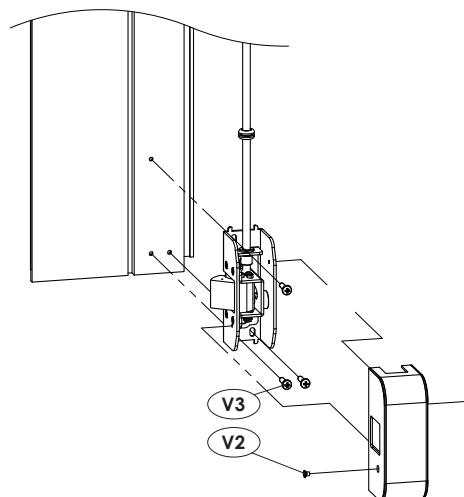
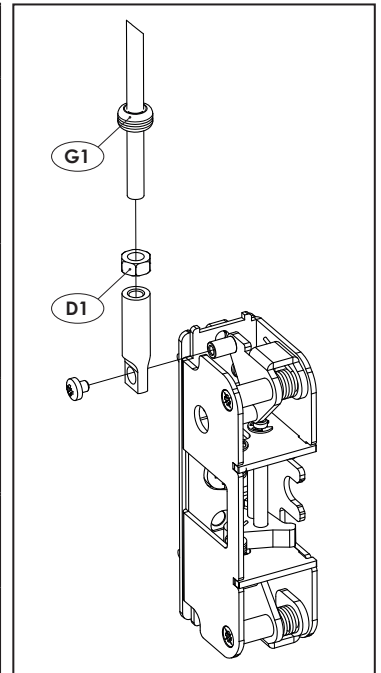

Asta filettata
Threaded rod
Tige filetée

Copertura per aste
Cover for rods
Protection pour tiges

